



Double Door - Not Divided Pantry Worksheet

Uses 4 "L" Bracket Installation On Base Shelves & 2 "RB" Bracket Installation For Non-Base Shelves

The *no middle shelf* type pantry will use:

- 4 "L" bracket method of installation for both the lower base and upper base shelves
- 2 "RB" bracket method for the non-base shelves

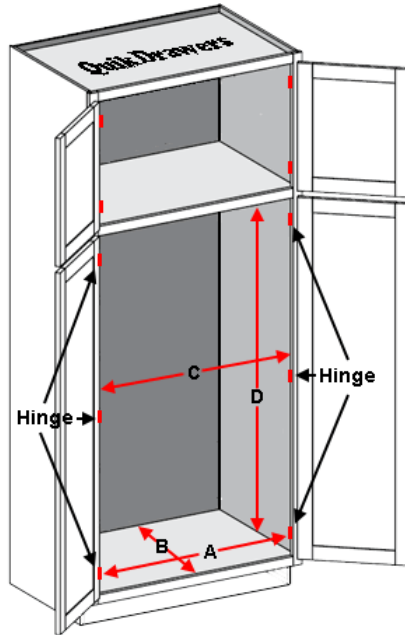

2 rear bracket installation for upper, non-base shelves

4 "L" bracket installation for bottom base and top base shelves

- A - From hinge to hinge (if present), otherwise from side of frame opening to opposite side of frame opening
- B - From rear wall to inside of face frame
- C - From side of frame opening to opposite side of frame opening, should be area clear of hinges
- D - From base shelf to upper fixed shelf

- A** Record the measurement from hinge to opposite side of opening. If there is no hinge, then measure from side of opening to opposite side of opening.
- B** Record the measure from the rear wall to the inside edge of the front face frame
- C** Record the distance from one side of the opening to the opposite side of the opening. The upper shelf area should be clear of any hinges
- D** Recode the height of the bottom opening

<u>Cabinet #</u>	<u>"A"</u>	<u>"B"</u>	<u>"C"</u>	<u>"D"</u>
_____	_____	_____	_____	_____
_____	_____	_____	_____	_____
_____	_____	_____	_____	_____
_____	_____	_____	_____	_____
_____	_____	_____	_____	_____